

Suspension | 220-240 V | 1xE27
8981

ErCCERoHS

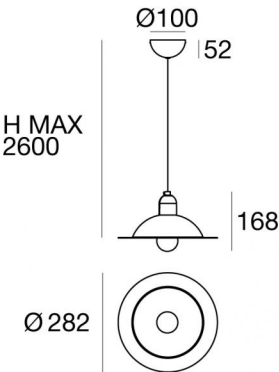
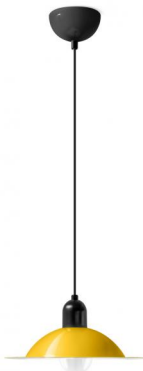

Données techniques	
Designer	De Pas - D'urbino - Lomazzi
Année de réalisation	1971
Typologie	Suspension
Position d'installation	Plafond
Environnement d'installation	Intérieur
Puissance	1 x 7 W
Culot de la lampe	1 x E27
Frequency	50-60 Hz
Optique	General Lighting
Light emission direction	downward
Classe d'isolation	1
IP	IP20
Essai au fil incandescent	650°
Montage direct sur des surfaces normalement inflammables	Oui
CE	Oui
Article à intensité variable	Non
Orientable	Non
Basculement	Non
Piétinable	Non
Carrossable	Non
Câble inclus	Oui
Longueur du câble	2.5 m
Revêtement en résine	Non
Poids net	0.725 Kg

Finition diffuseur	
Matériau	Aluminium - Aluminium
Couleur	blanc RAL 9016 - RAL 1003 jaune
Fabrication	Revêtement en poudre - Revêtement en poudre
Finition monture	
Matériau	métal
Couleur	noir RAL 9005
Fabrication	Vernissage
Cables Suspension	
Longueur max de	2500 mm



Suspension | 220-240 V | 1xE27
8981

Single emission pendant luminaires for indoor application. LED
lamplamp included, lamp cap 1xE27.

The diffuser is made of aluminium with a powder coating treatment the
diffuser is made of aluminium with a powder coating treatment; the
mounting frame is made of metal, with a black ral 9005 finish, processed
by means of coating. The ingress protection degree is IP20; the total
weight is of 0.725 kg.

. The power supply cable is included and features a 2.5 m lenght.

The device features protection class I and can be ceiling-mounted.

Compliant with the EN 60598-1 standard and its specific provisions.

Classe d'efficacité énergétique

Ce produit contient une source lumineuse de classe d'efficacité
énergétique A++.

Caractéristiques Techniques de l'éclairage

Flux lumineux (source)	806 lm
Température de couleur	2700 K
Indice de rendu chromatique	80 Ra

Lampiatta



Suspension | 220-240 V | 1xE27
8990

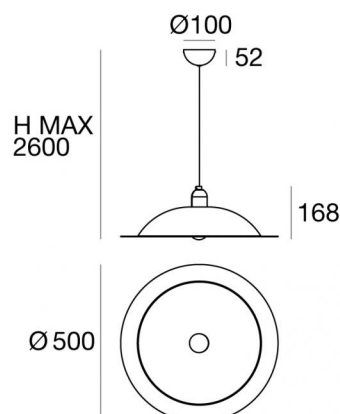

Données techniques

Designer	De Pas - D'urbino - Lomazzi
Année de réalisation	1971
Typologie	Suspension
Position d'installation	Plafond
Environnement d'installation	Intérieur
Puissance	1 x 11 W
Culot de la lampe	1 x E27
Frequency	50-60 Hz
Optique	General Lighting
Light emission direction	downward
Classe d'isolation	1
IP	IP20
Essai au fil incandescent	650°
Montage direct sur des surfaces normalement inflammables	Oui
CE	Oui
Article à intensité variable	Non
Orientable	Non
Basculement	Non
Piétinable	Non
Carrossable	Non
Câble inclus	Oui
Longueur du câble	2.5 m
Revêtement en résine	Non
Poids net	1.44 Kg

Finition diffuseur

Matériau	Aluminium - Aluminium
Couleur	RAL 1003 jaune - blanc RAL 9016
Fabrication	Revêtement en poudre - Revêtement en poudre

Finition monture

Matériau	métal
Couleur	blanc RAL 9016
Fabrication	Vernissage

Cables Suspension

Longueur max de	2500 mm
-----------------	---------



Suspension | 220-240 V | 1xE27
8990

Single emission pendant luminaires for indoor application. LED
lamplamp included, lamp cap 1xE27.

The diffuser is made of aluminium with a powder coating treatment the
diffuser is made of aluminium with a powder coating treatment; the
mounting frame is made of metal, with a white ral 9016 finish, processed
by means of coating. The ingress protection degree is IP20; the total
weight is of 1.44 kg.

. The power supply cable is included and features a 2.5 m lenght.

The device features protection class I and can be ceiling-mounted.

Compliant with the EN 60598-1 standard and its specific provisions.

Classe d'efficacité énergétique	
Ce produit contient une source lumineuse de classe d'efficacité énergétique A+.	
Caractéristiques Techniques de l'éclairage	
Flux lumineux (source)	1520 lm
Température de couleur	2700 K
Indice de rendu chromatique	80 Ra

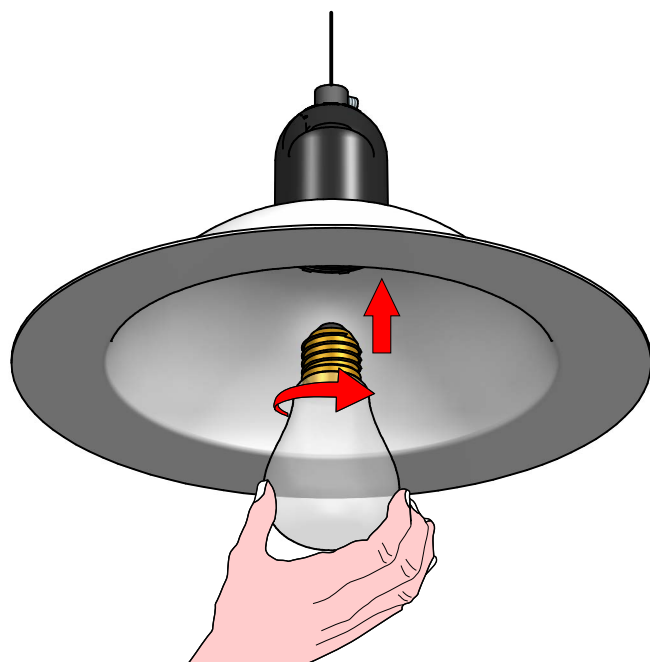

Classic A Retrofit



LED Bulb
7 W 806 lm
2700 K CRI \geq 80
INCLUDED

- 8981
- 8982
- 8983
- 8984
- 8985

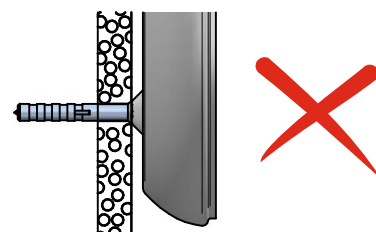
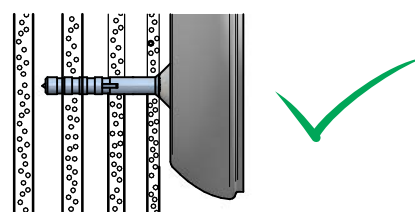
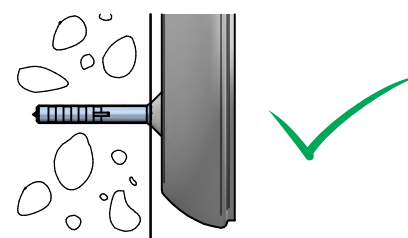
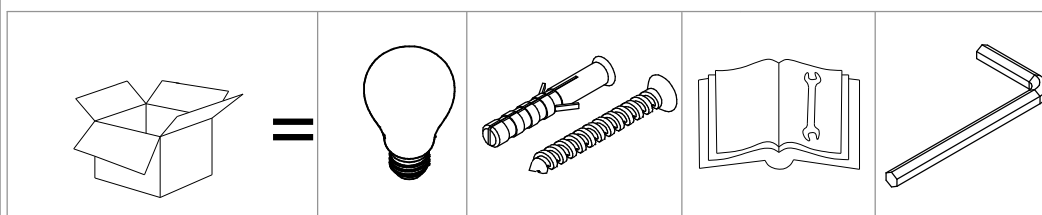
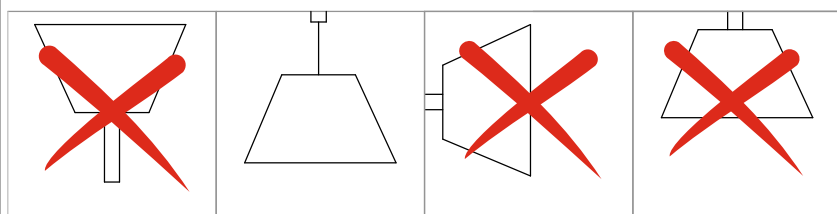
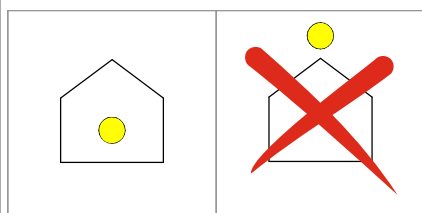
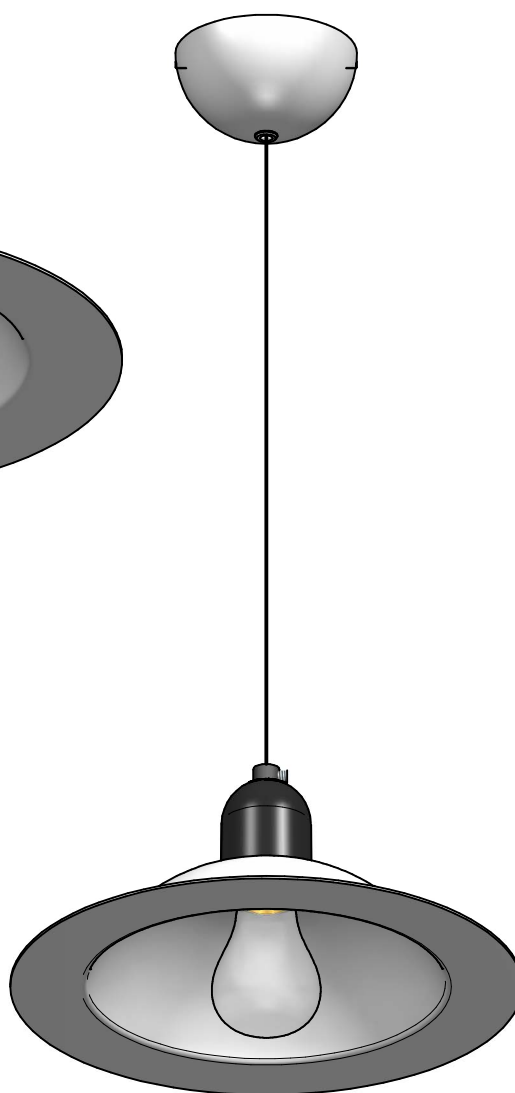

1

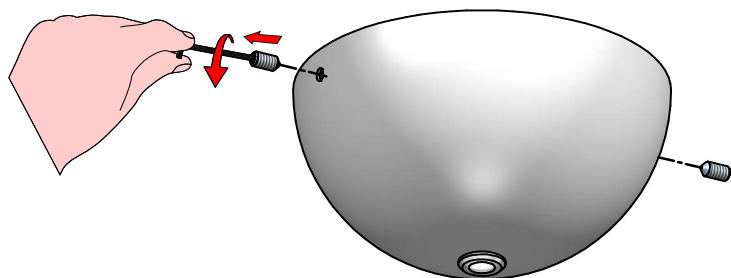

2

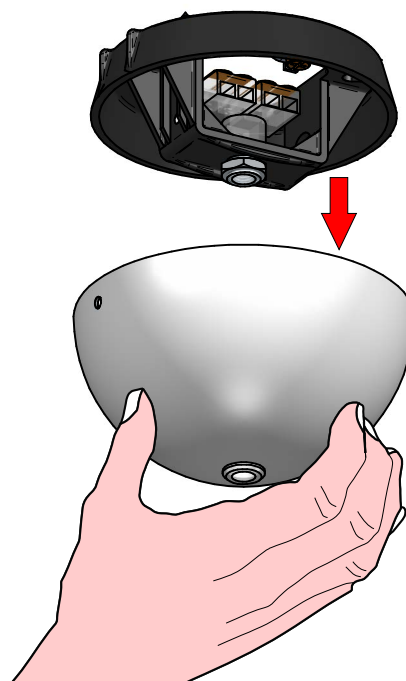

3

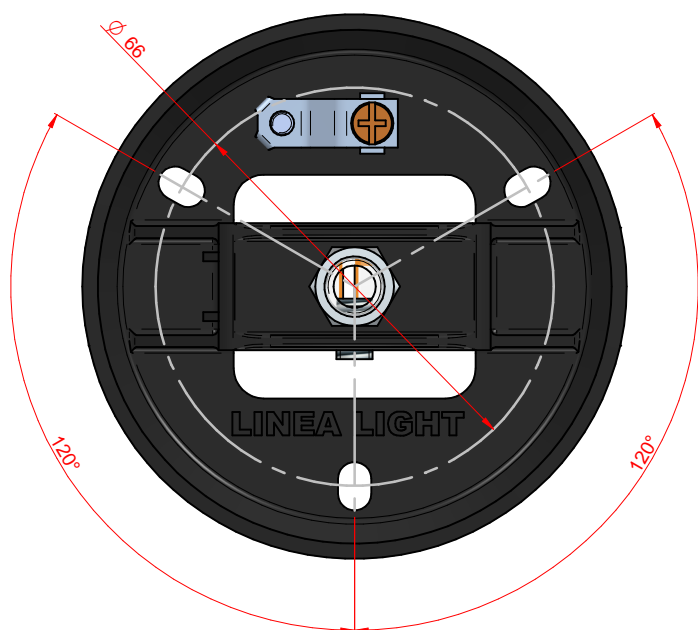

4

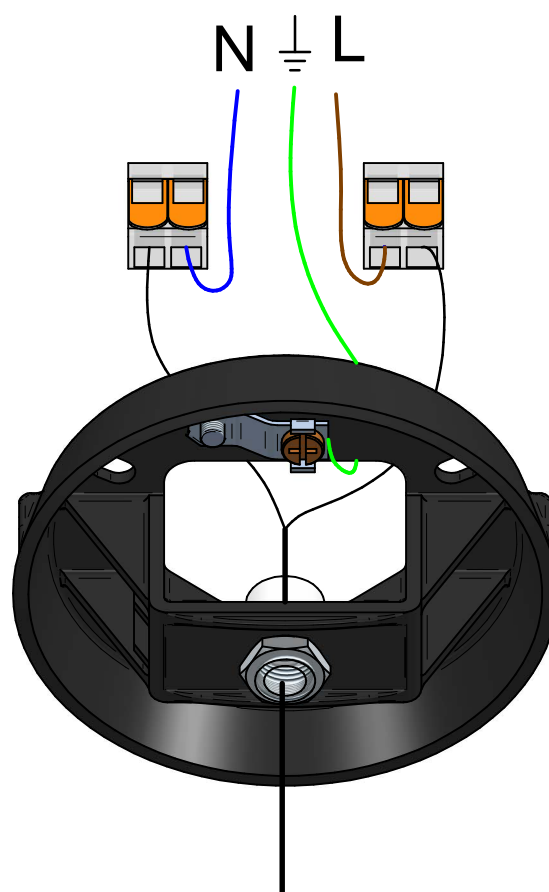

5

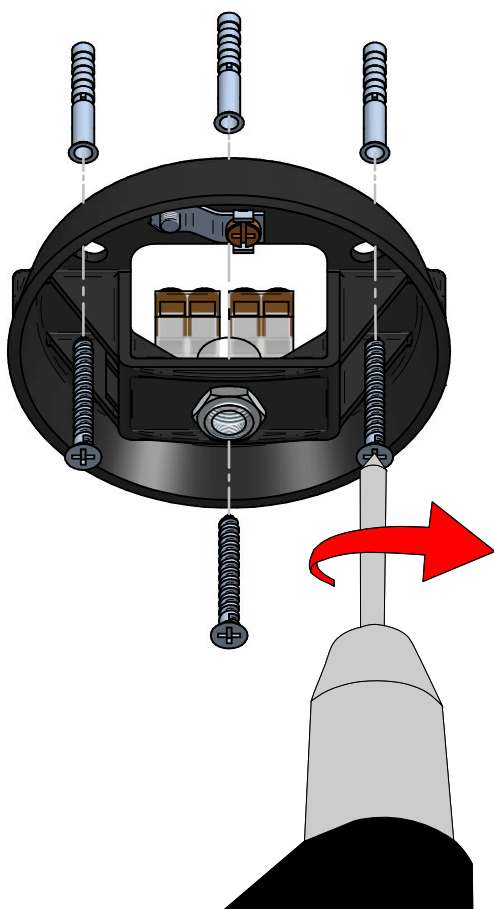

6

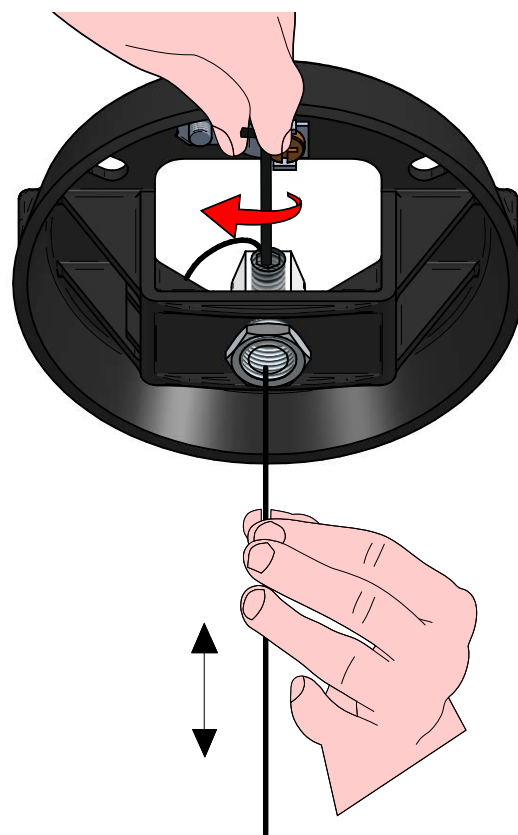

7

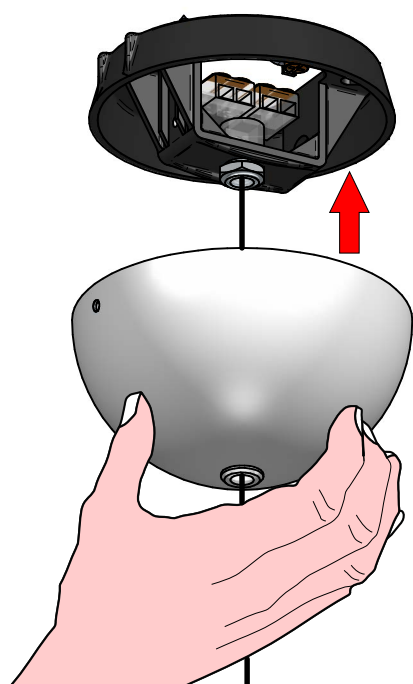

8

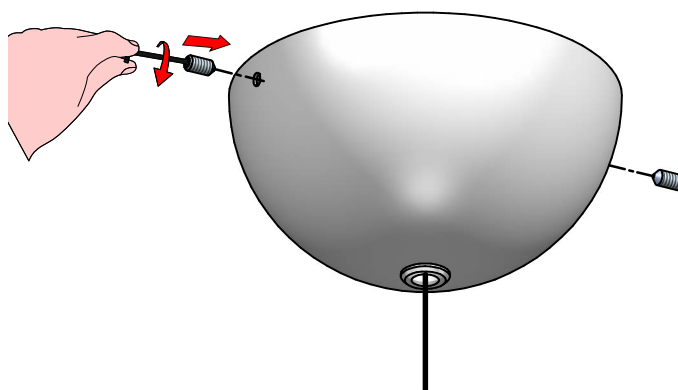

9

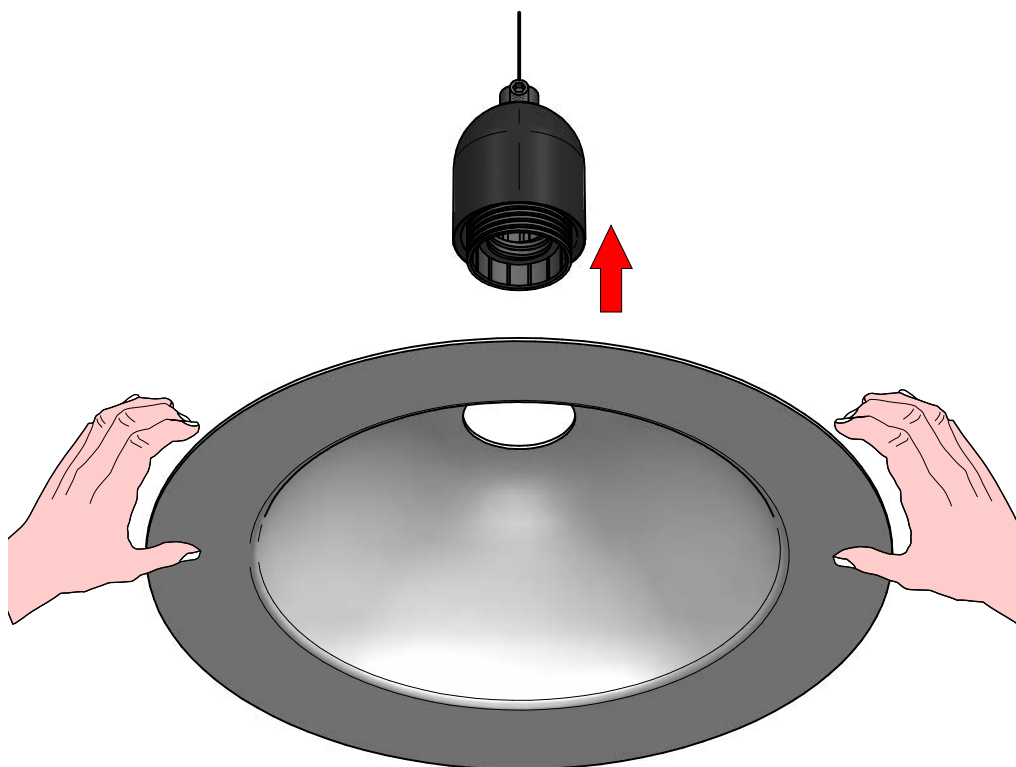

10

